

  
**THE CHESTER GROSVENOR**  

---

**MEETINGS AND EVENTS**

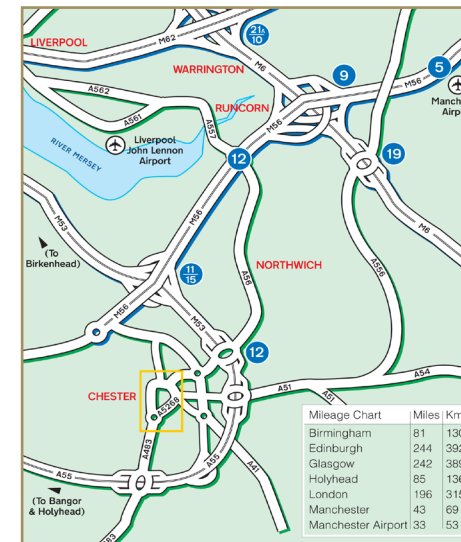

**LOCATION**

**TRAIN STATION**

- Chester, 1.2 miles, 7 minutes by car

**AIRPORT**

- Manchester International Airport, 33 miles, 40 minutes by car
- Liverpool John Lennon Airport, 25 miles, 40 minutes by car

**MOTORWAY**

- M53, Junction 12, 3.4 miles, 9 minutes by car

**NEAREST CAR PARK**

- The Grosvenor Shopping Centre Car Park, Newgate Street, Chester, CH1 1DE



**THE CHESTER GROSVENOR**

Eastgate Chester CH1 1LT

01244 324024

Hotel@ChesterGrosvenor.com

www.ChesterGrosvenor.com



**THE HOTEL AND ITS HISTORY**

The Chester Grosvenor, a luxury five AA red star hotel, ranked as an Inspectors' Choice property has been long established in Chester, Cheshire since its creation in 1865.

Owned by the Duke of Westminster and holding status as a Grade II listed building, this Cestrian landmark rests firmly in the hearts of its guests.

The hotel offers 67 stylish bedrooms and 12 sophisticated suites, each individually designed with rich wall coverings and the finest fabrics, offering a traditional yet contemporary style.

Located on Eastgate, Chester's famed high street, The Chester Grosvenor sits next to the famous Eastgate Clock and close to Chester Cathedral, Chester Racecourse, the historic Roman walls and a short drive from the award-winning Chester Zoo.

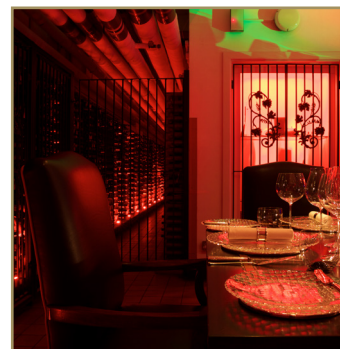

**MEETINGS AND EVENTS**

The Chester Grosvenor offers state of the art facilities with stylish surroundings and world class service.

- Up to 10 versatile meeting and event rooms
- Up to 250 delegates, theatre style
- Inbuilt audio visual, PA system, on-site technical support
- Bespoke colour ceiling spotlights
- Wheelchair accessible
- Available for exclusive use

**TEAM ACTIVITIES**

Reward your team in the historic city of Chester. Team events can be seamlessly added into your itinerary.

- Falconry experiences at Chester Cathedral
- City centre treasure hunts
- Champagne, wine and gin experiences
- Personal tours of Chester Zoo
- River cruise, kayaking and pedalo fun
- Historic tours, ghost discovery trails

**SPA**

Immerse yourself in the serenity of our boutique spa sanctuary, designed to evoke relaxation, vitality and total wellbeing.

- Five treatment rooms, relaxation lounge and Thermal Suite
- ELEMIS and Jessica product partners
- Bespoke packages, perfect for incentives
- Fully equipped gym
- Exclusive use available

**DINING**

Award-winning dining. 'Red star' service

- 'Simon Radley at The Chester Grosvenor' - Michelin starred dining since 1990, 4 AA Rosettes
- La Brasserie - modern, fresh cooking using flavours and ingredients from home and abroad, 2 AA Rosettes
- Private dining for up to 200 guests
- One of the most extensive wine cellars in England, with over 900 bins
- Unique and bespoke menus designed especially for you
- Entertainment to complement

# MEETING ROOMS & CAPACITIES



## KEY

- VGA input
- Telephone socket
- Ethernet connection
- Power socket
- 3 phase power
- TV aerial

## THE WESTMINSTER SUITE

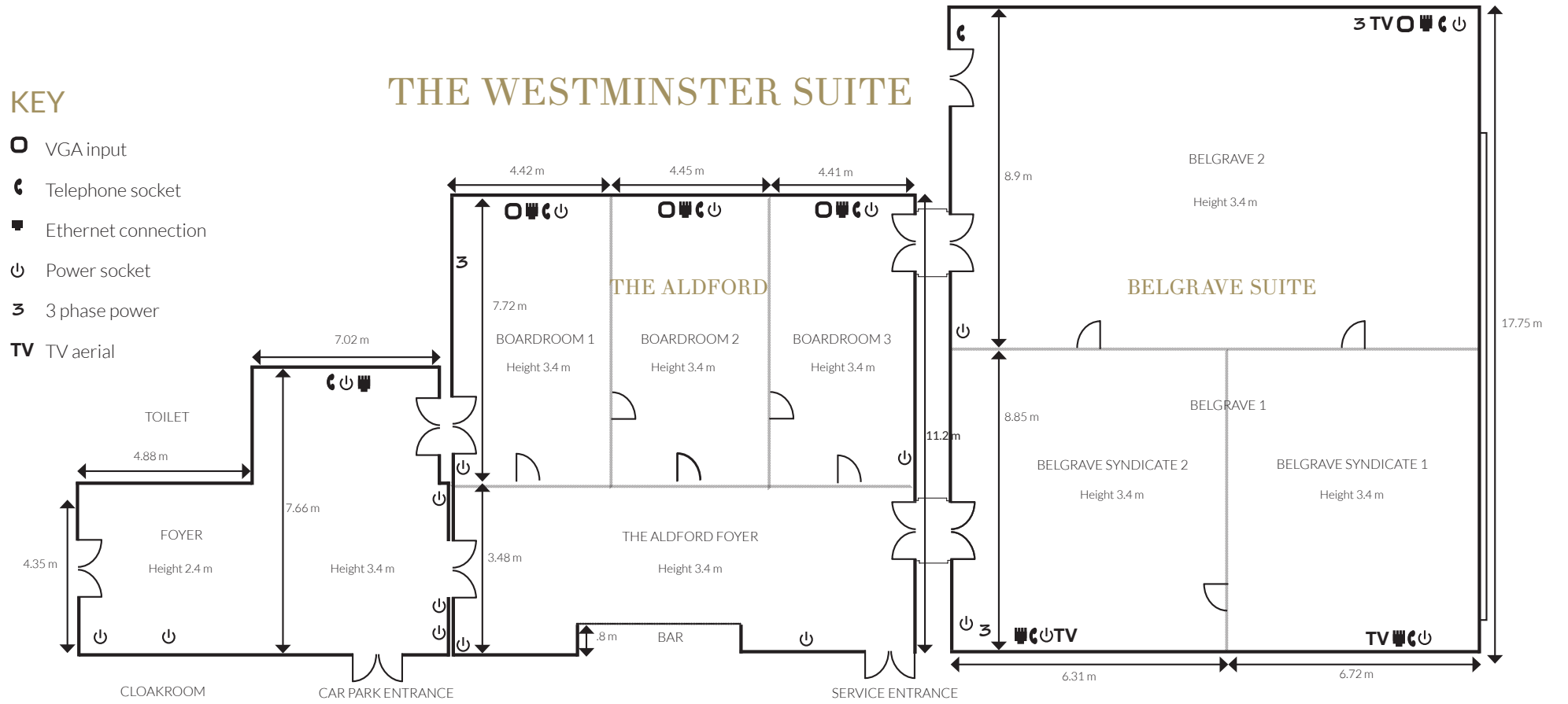

## THE RIEDEL CELLAR

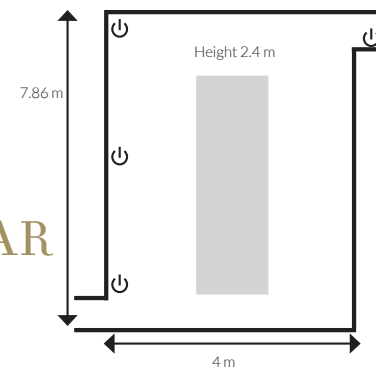

## THE EATON SUITE

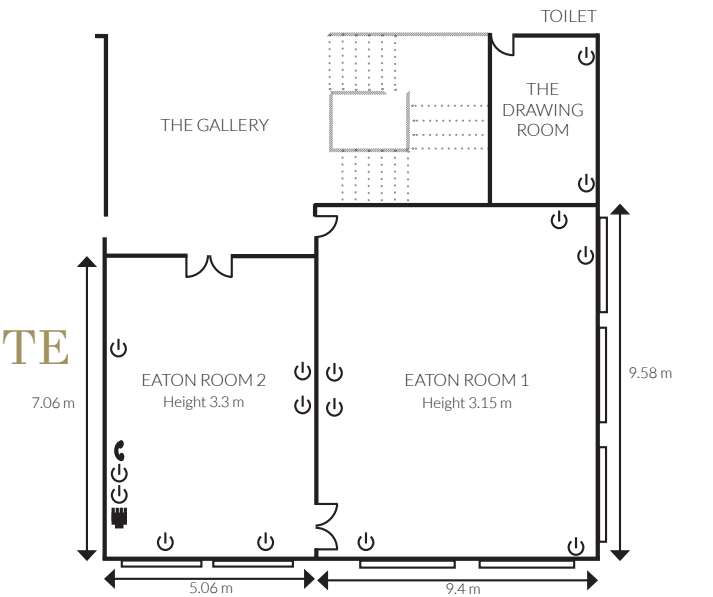

EVENT ROOM	CABARET	THEATRE	CLASSROOM	BOARDROOM	U-SHAPE	HOLLOW SQUARE	RECEPTION	PRIVATE DINNER OVAL	PRIVATE DINNER ROUNDS	PRIVATE DINNER SPRIGS	DINNER DANCE ROUNDS
Belgrave Suite	128	250	100	76	62	76	350	50	192	220	160
Belgrave with Back Projection	112	180	76	N/A	N/A	N/A	250	N/A	168	N/A	160
Belgrave 1 or 2	64	125	50	28	34	42	175	28	84	55	48
Belgrave Syndicate 1 or 2	24	50	24	20	24	30	75	20	36	N/A	N/A
The Aldford	64	100	56	36	38	52	150	36	96	N/A	72
The Aldford (with wall in)	48	84	44	28	31	46	100	28	72	N/A	36
Aldford Room 1/2 or 2/3	32	50	24	20	22	26	60	20	48	N/A	N/A
Aldford Boardroom 1, 2, 3	16	25	12	12	15	18	30	12	24	N/A	N/A
Westminster Foyer	N/A	N/A	N/A	N/A	N/A	N/A	60	N/A	N/A	N/A	N/A
Eaton Room 1	40	80	28	28	30	40	100	N/A	N/A	N/A	N/A
Eaton Room 2	N/A	N/A	N/A	12	N/A	N/A	20	N/A	N/A	N/A	N/A
The Riedel Cellar	N/A	N/A	N/A	14	N/A	N/A	20	14	N/A	N/A	N/A